

ASSEMBLED

200 SERIES

Item	Description	Qty.
223	INTERNAL EXTERNAL GEAR - 10P DR 1/4 C.P	1
224	BDRED (DRIVE) GEAR - 10P DR 1/2 C.P	1
C225	END CAP	1
226	WASHER	1
227	THRUST BEARING	4
227A	THRUST WASHER	8
228	BEARING	2
229	RACE	2
230	PEANUT PIN	3
231	PEANUT GEAR	3
232	PEANUT GEAR BEARING	3
233	PEANUT GEAR RACE	3
C236	REGISTER SHAFT	1
308	INNER RACE	2
309	SPACER BUSHING	1
001	1/4-28 GREASE FITTING 90°	3
000	1/8-27 GREASE FITTING STRAIGHT	1
001	1/4-20 x 3/4 LONG HEX HEAD	2
002	1/4 LOCK WASHER	2

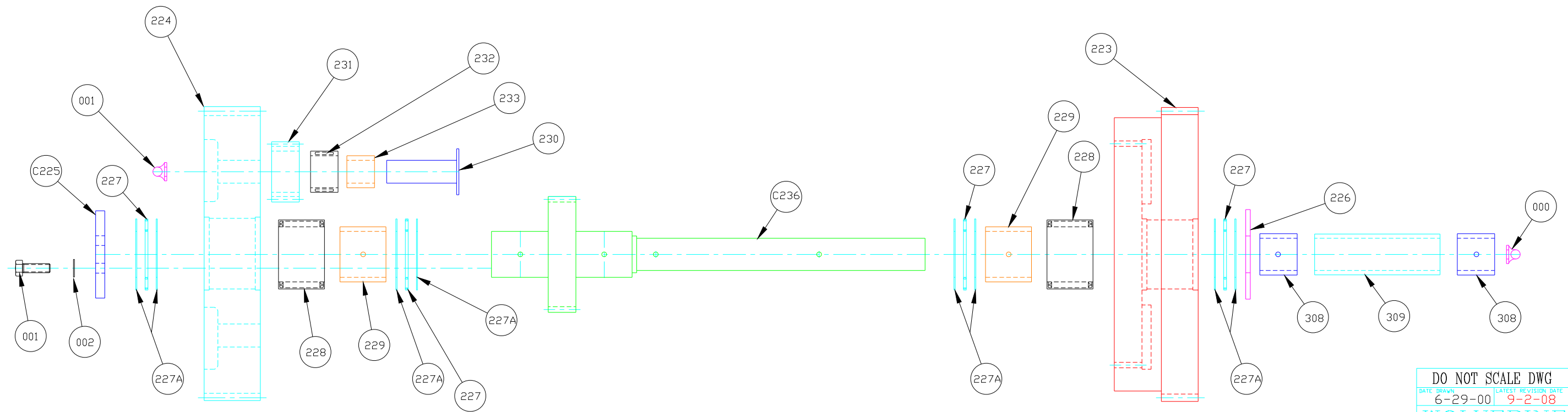

224 360° REGISTER ASSEMBLY

DO NOT SCALE DWG		
DATE DRAWN	LATEST REVISION DATE	
6-29-00	9-2-08	
WOLVERINE FLEXOGRAPHIC MFG. CO. FARMINGTON, MICH. 48336		
PRODUCT CIRE-CICL		
PART REGISTER ASSEMBLY		
DESIGN	SCALE	ORDER NO.
DETAIL JOHN		
CHECKED	DRAWING NO.	
APPROVED	200C224A	